

Nedcon Smart Standard Range Upright frames assembly

07/2013

Ver. 1.1

Contact information

Nedcon Magazijninrichting BV

Nijverheidsweg 26
7005 BJ Doetinchem
PO box 35
7000 AA Doetinchem

+31 314 334455
info@nedcon.com

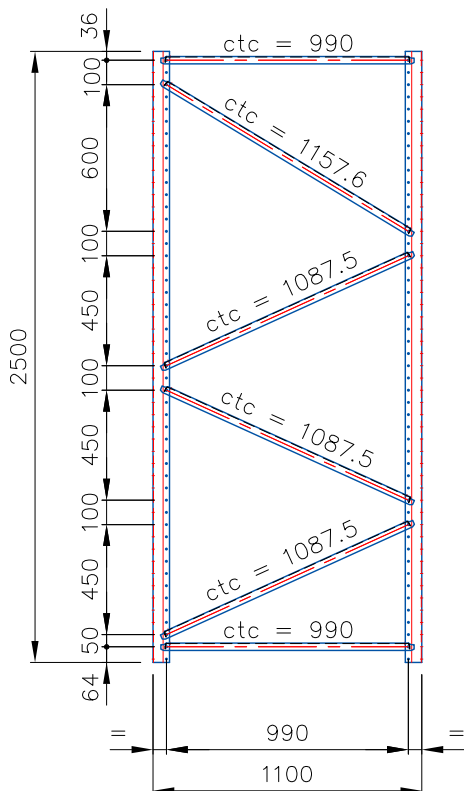

Detail of diagonal

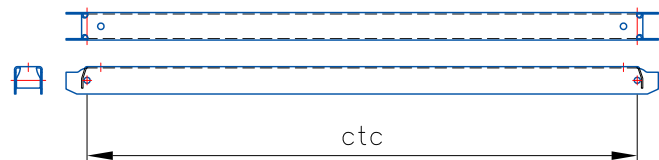

Set SSR Frame 8067204050 2500x1100		Part nr. 50259
Upright 8067204050 PR 355 2500, R5019		2x
Diag. 503015-275 6.6 ctc= 990.00,RAL5019		2x
Diag. 503015-275 6.6 ctc=1087.47,RAL5019		3x
Diag. 503015-275 6.6 ctc=1157.63,RAL5019		1x
Bolt hexhd flange M6x 70 zinc 8.8		12x
Nut hex flange selflocking M6 zinc 8.8		12x
Baseplate low 5.0 mm 100, RAL5019		2x
Bolt tapping hexhd M10x 25 zinc 8.8		4x
Nut hex toothed flange M10 zinc 8.8		4x
Washer nonchamfer M10 zinc		4x
CM Shim 100, 1.0 mm, sendz		2x
CM Shim 100, 2.0 mm, sendz		2x

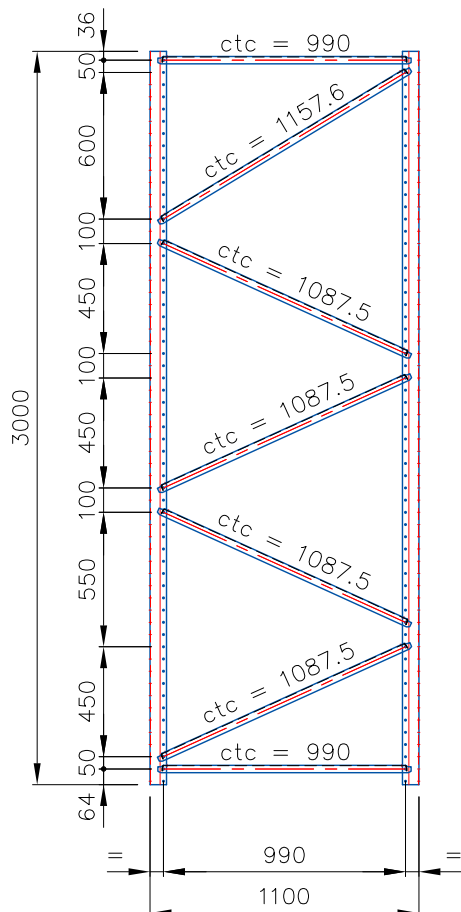

Detail of diagonal

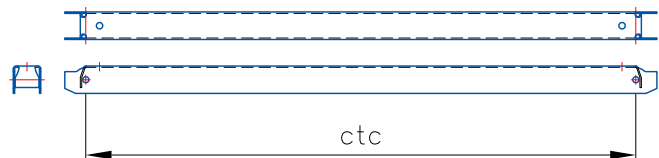

Set SSR Frame 8067204050 3000x1100		Part nr. 50260
Upright 8067204050 PR 355 3000, R5019		2x
Diag. 503015-275 6.6 ctc= 990.00,RAL5019		2x
Diag. 503015-275 6.6 ctc=1087.47,RAL5019		4x
Diag. 503015-275 6.6 ctc=1157.63,RAL5019		1x
Bolt hexhd flange M6x 70 zinc 8.8		14x
Nut hex flange selflocking M6 zinc 8.8		14x
Baseplate low 5.0 mm 100, RAL5019		2x
Bolt tapping hexhd M10x 25 zinc 8.8		4x
Nut hex toothed flange M10 zinc 8.8		4x
Washer nonchamfer M10 zinc		4x
CM Shim 100, 1.0 mm, sendz		2x
CM Shim 100, 2.0 mm, sendz		2x

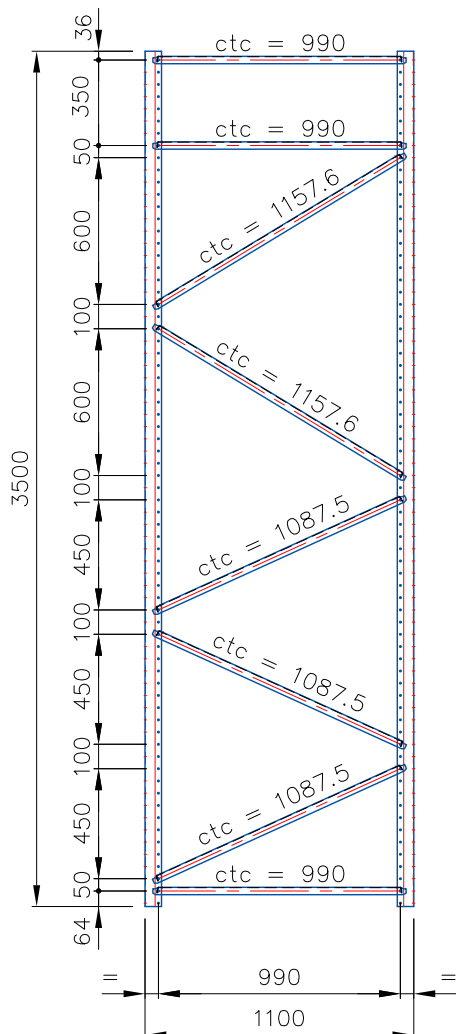

Detail of diagonal

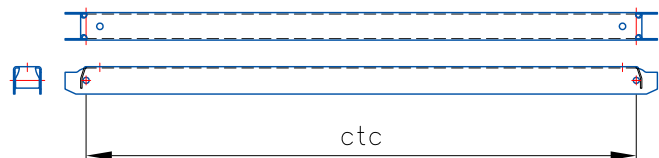

Set SSR Frame 8067204050 3500x1100		Part nr. 50311
Upright 8067204050 PR 355 3500, R5019		2x
Diag. 503015-275 6.6 ctc= 990.00,RAL5019		3x
Diag. 503015-275 6.6 ctc=1087.47,RAL5019		3x
Diag. 503015-275 6.6 ctc=1157.63,RAL5019		2x
Bolt hexhd flange M6x 70 zinc 8.8		16x
Nut hex flange selflocking M6 zinc 8.8		16x
Baseplate low 5.0 mm 100, RAL5019		2x
Bolt tapping hexhd M10x 25 zinc 8.8		4x
Nut hex toothed flange M10 zinc 8.8		4x
Washer nonchamfer M10 zinc		4x
CM Shim 100, 1.0 mm, sendz		2x
CM Shim 100, 2.0 mm, sendz		2x

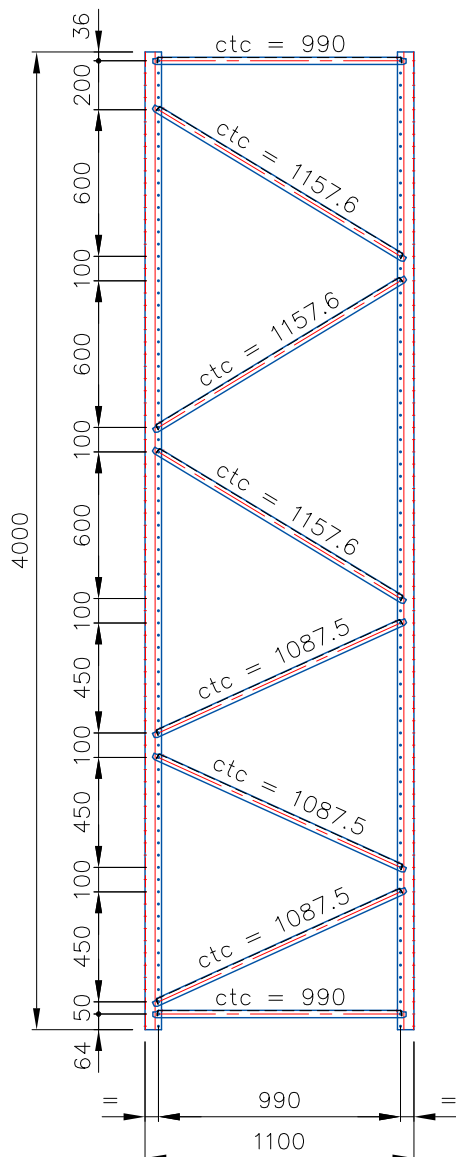

Detail of diagonal

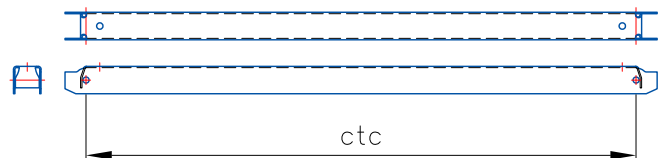

Set SSR Frame 8067204050 4000x1100	Part nr. 50312
Upright 8067204050 PR 355 4000, R5019	2x
Diag. 503015-275 6.6 ctc= 990.00,RAL5019	2x
Diag. 503015-275 6.6 ctc=1087.47,RAL5019	3x
Diag. 503015-275 6.6 ctc=1157.63,RAL5019	3x
Bolt hexhd flange M6x 70 zinc 8.8	16x
Nut hex flange selflocking M6 zinc 8.8	16x
Baseplate low 5.0 mm 100, RAL5019	2x
Bolt tapping hexhd M10x 25 zinc 8.8	4x
Nut hex toothed flange M10 zinc 8.8	4x
Washer nonchamfer M10 zinc	4x
CM Shim 100, 1.0 mm, sendz	2x
CM Shim 100, 2.0 mm, sendz	2x

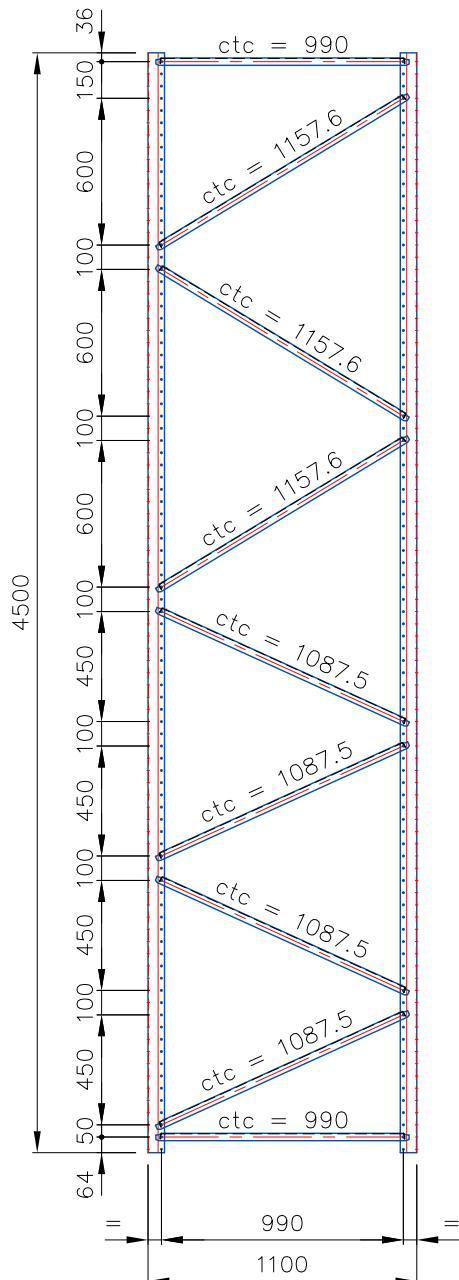

Detail of diagonal

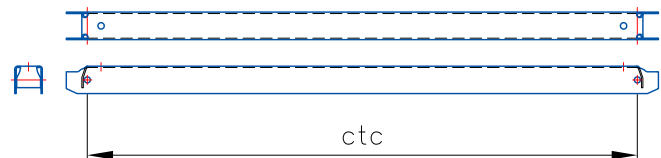

Set SSR Frame 8067204050 4500x1100		Part nr. 50313
Upright 8067204050 PR 355 4500, R5019		2x
Diag. 503015-275 6.6 ctc= 990.00,RAL5019		2x
Diag. 503015-275 6.6 ctc=1087.47,RAL5019		4x
Diag. 503015-275 6.6 ctc=1157.63,RAL5019		3x
Bolt hexhd flange M6x 70 zinc 8.8		18x
Nut hex flange selflocking M6 zinc 8.8		18x
Baseplate low 5.0 mm 100, RAL5019		2x
Bolt tapping hexhd M10x 25 zinc 8.8		4x
Nut hex toothed flange M10 zinc 8.8		4x
Washer nonchamfer M10 zinc		4x
CM Shim 100, 1.0 mm, sendz		2x
CM Shim 100, 2.0 mm, sendz		2x

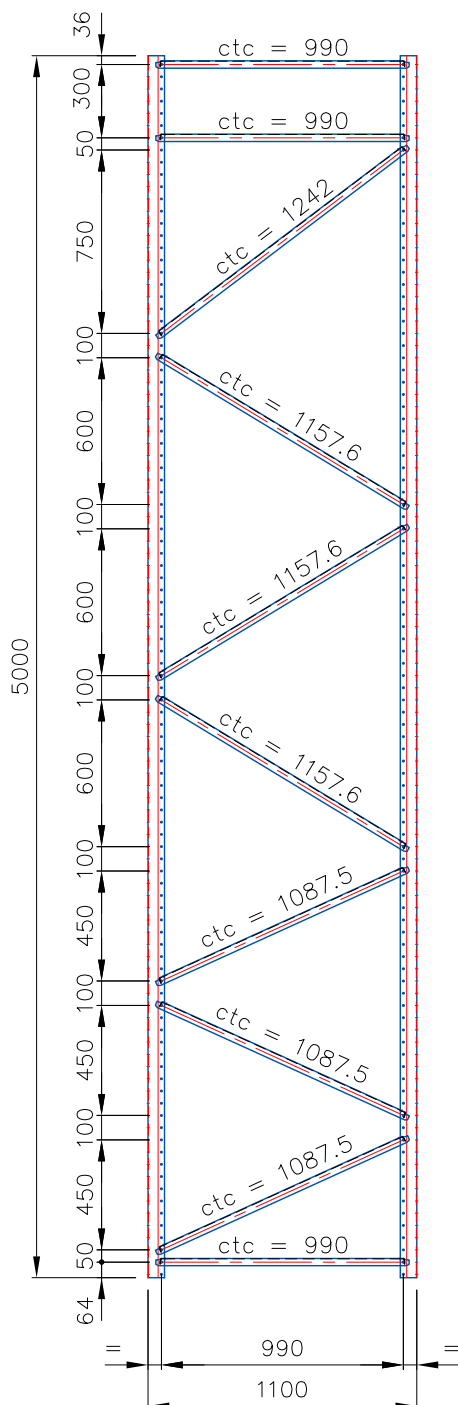

Detail of diagonal

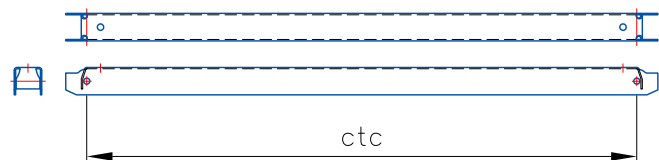

Set SSR Frame 8067204050 5000x1100		Part nr. 50314
Upright 8067204050 PR 355 5000, R5019		2x
Diag. 503015-275 6.6 ctc= 990.00,RAL5019		3x
Diag. 503015-275 6.6 ctc=1087.47,RAL5019		3x
Diag. 503015-275 6.6 ctc=1157.63,RAL5019		3x
Diag. 503015-275 6.6 ctc=1242.01,RAL5019		1x
Bolt hexhd flange M6x 70 zinc 8.8		20x
Nut hex flange selflocking M6 zinc 8.8		20x
Baseplate low 5.0 mm 100, RAL5019		2x
Bolt tapping hexhd M10x 25 zinc 8.8		4x
Nut hex toothed flange M10 zinc 8.8		4x
Washer nonchamfer M10 zinc		4x
CM Shim 100, 1.0 mm, sendz		2x
CM Shim 100, 2.0 mm, sendz		2x

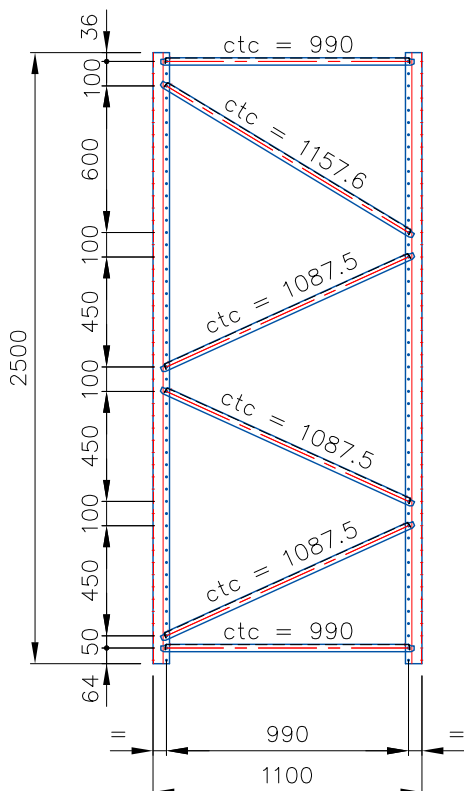

Detail of diagonal

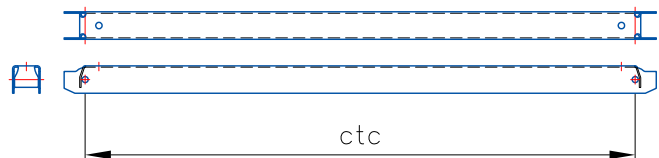

Set SSR Frame 10068204050 2500x1100	Part nr. 50315
Upright 10068204050 PR 355 2500, R5019	2x
Diag. 503015-275 6.6 ctc= 990.00,RAL5019	2x
Diag. 503015-275 6.6 ctc=1087.47,RAL5019	3x
Diag. 503015-275 6.6 ctc=1157.63,RAL5019	1x
Bolt hexhd flange M6x 70 zinc 8.8	12x
Nut hex flange selflocking M6 zinc 8.8	12x
Baseplate low 5.0 mm 100, RAL5019	2x
Bolt tapping hexhd M10x 25 zinc 8.8	4x
Nut hex toothed flange M10 zinc 8.8	4x
Washer nonchamfer M10 zinc	4x
CM Shim 100, 1.0 mm, sendz	2x
CM Shim 100, 2.0 mm, sendz	2x

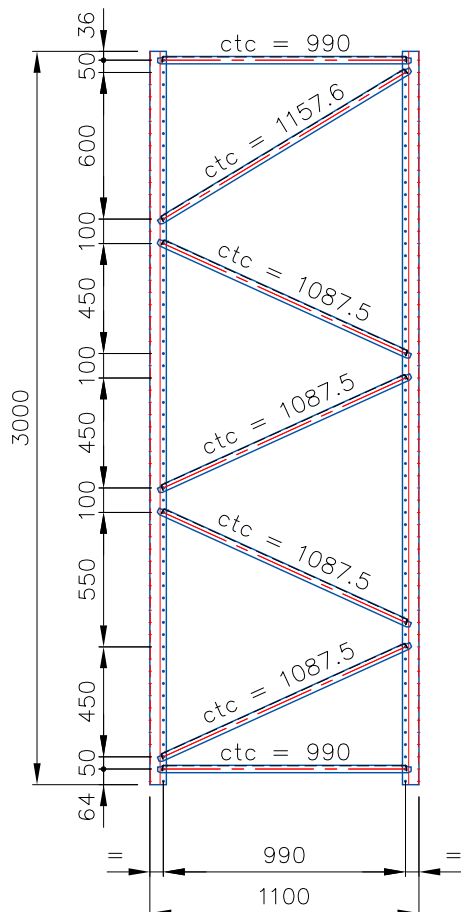

Detail of diagonal

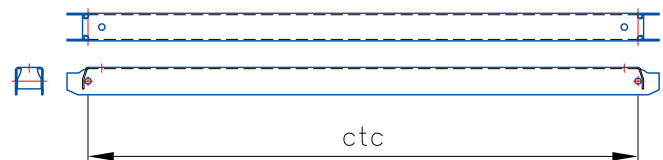

Set SSR Frame 10068204050 3000x1100	Part nr. 50316
Upright 10068204050 PR 355 3000, R5019	2x
Diag. 503015-275 6.6 ctc= 990.00,RAL5019	2x
Diag. 503015-275 6.6 ctc=1087.47,RAL5019	4x
Diag. 503015-275 6.6 ctc=1157.63,RAL5019	1x
Bolt hexhd flange M6x 70 zinc 8.8	14x
Nut hex flange selflocking M6 zinc 8.8	14x
Baseplate low 5.0 mm 100, RAL5019	2x
Bolt tapping hexhd M10x 25 zinc 8.8	4x
Nut hex toothed flange M10 zinc 8.8	4x
Washer nonchamfer M10 zinc	4x
CM Shim 100, 1.0 mm, sendz	2x
CM Shim 100, 2.0 mm, sendz	2x

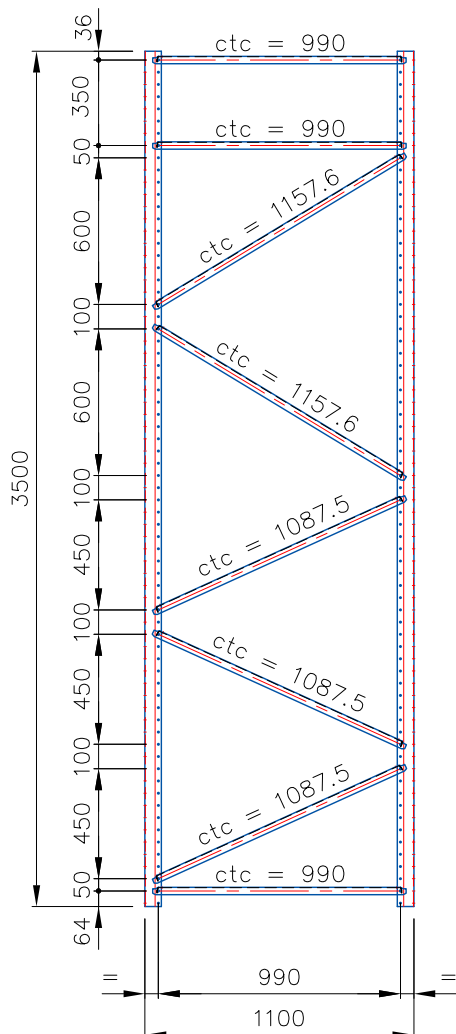

Detail of diagonal

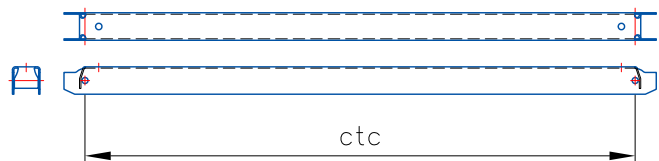

Set SSR Frame 10068204050 3500x1100	Part nr. 50317
Upright 10068204050 PR 355 3500, R5019	2x
Diag. 503015-275 6.6 ctc= 990.00,RAL5019	3x
Diag. 503015-275 6.6 ctc=1087.47,RAL5019	3x
Diag. 503015-275 6.6 ctc=1157.63,RAL5019	2x
Bolt hexhd flange M6x 70 zinc 8.8	16x
Nut hex flange selflocking M6 zinc 8.8	16x
Baseplate low 5.0 mm 100, RAL5019	2x
Bolt tapping hexhd M10x 25 zinc 8.8	4x
Nut hex toothed flange M10 zinc 8.8	4x
Washer nonchamfer M10 zinc	4x
CM Shim 100, 1.0 mm, sendz	2x
CM Shim 100, 2.0 mm, sendz	2x

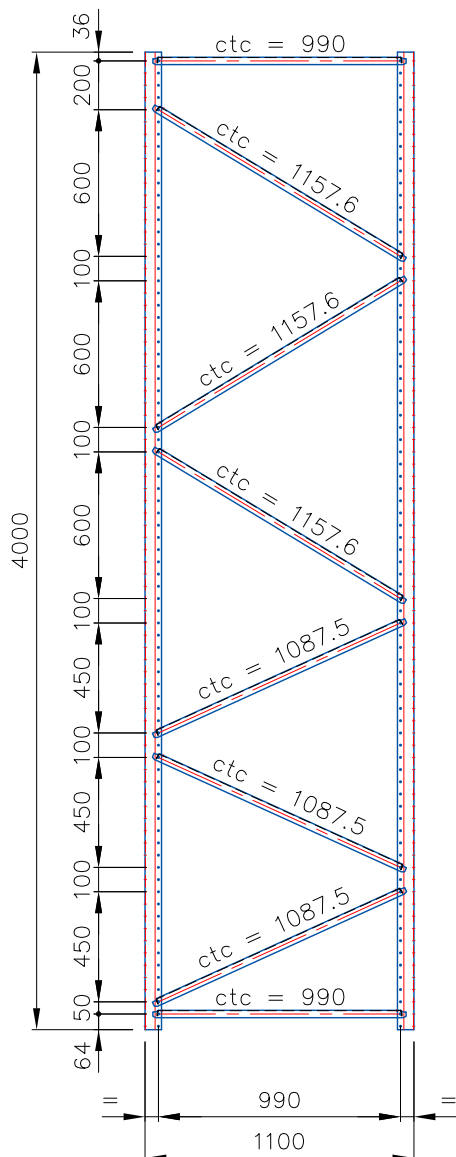

Detail of diagonal

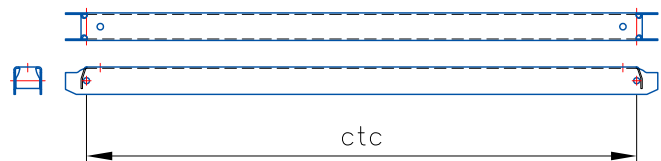

Set SSR Frame 10068204050 4000x1100	Part nr. 50318
Upright 10068204050 PR 355 4000, R5019	2x
Diag. 503015-275 6.6 ctc= 990.00,RAL5019	2x
Diag. 503015-275 6.6 ctc=1087.47,RAL5019	3x
Diag. 503015-275 6.6 ctc=1157.63,RAL5019	3x
Bolt hexhd flange M6x 70 zinc 8.8	16x
Nut hex flange selflocking M6 zinc 8.8	16x
Baseplate low 5.0 mm 100, RAL5019	2x
Bolt tapping hexhd M10x 25 zinc 8.8	4x
Nut hex toothed flange M10 zinc 8.8	4x
Washer nonchamfer M10 zinc	4x
CM Shim 100, 1.0 mm, sendz	2x
CM Shim 100, 2.0 mm, sendz	2x

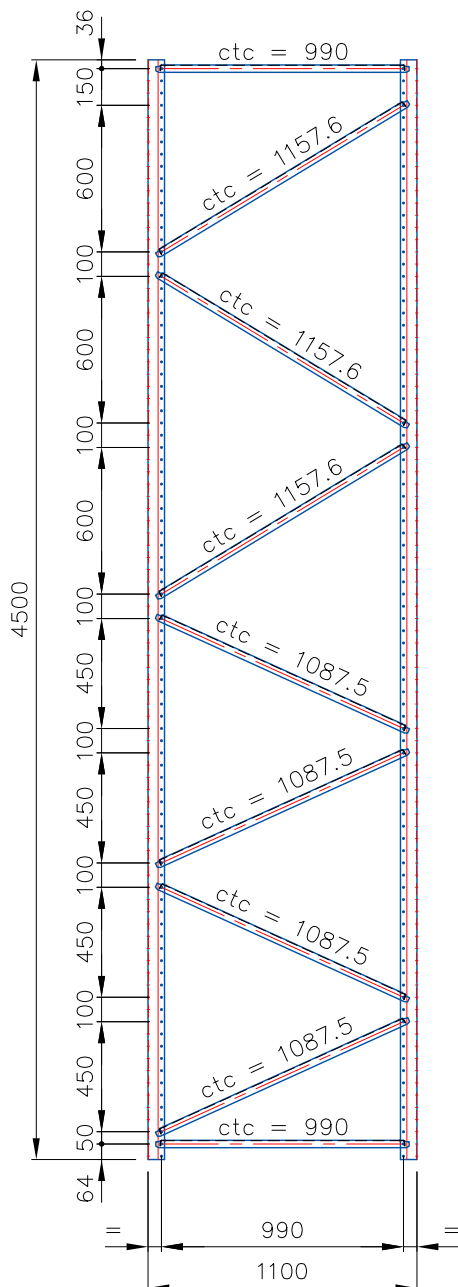

Detail of diagonal

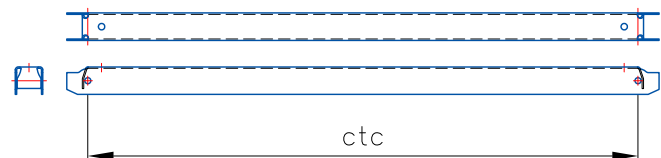

Set SSR Frame 10068204050 4500x1100	Part nr.
	50319
Upright 10068204050 PR 355 4500, R5019	2x
Diag. 503015-275 6.6 ctc= 990.00,RAL5019	2x
Diag. 503015-275 6.6 ctc=1087.47,RAL5019	4x
Diag. 503015-275 6.6 ctc=1157.63,RAL5019	3x
Bolt hexhd flange M6x 70 zinc 8.8	18x
Nut hex flange selflocking M6 zinc 8.8	18x
Baseplate low 5.0 mm 100, RAL5019	2x
Bolt tapping hexhd M10x 25 zinc 8.8	4x
Nut hex toothed flange M10 zinc 8.8	4x
Washer nonchamfer M10 zinc	4x
CM Shim 100, 1.0 mm, sendz	2x
CM Shim 100, 2.0 mm, sendz	2x

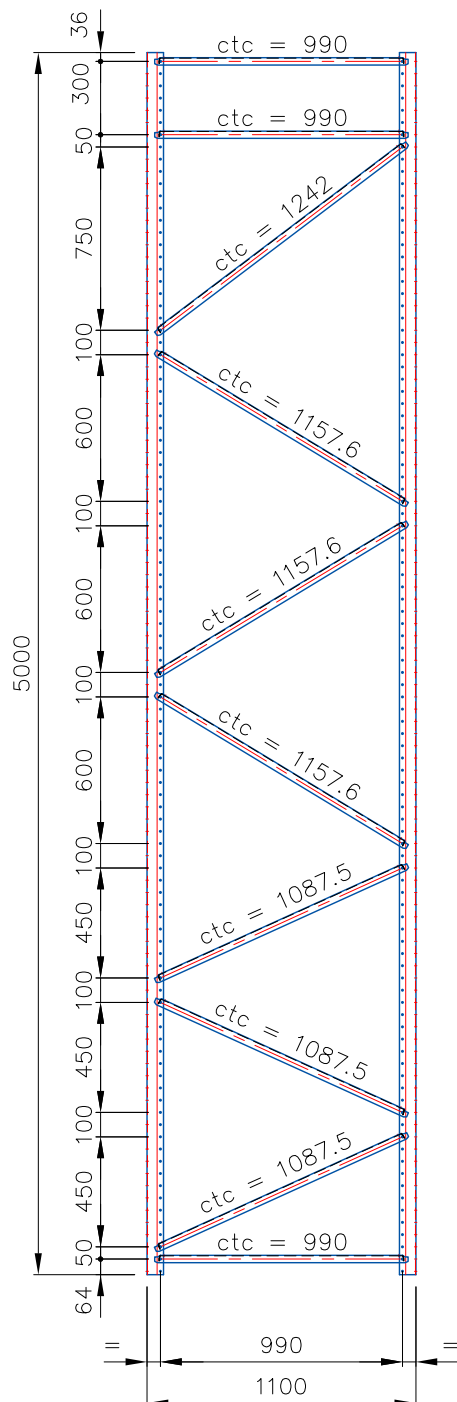

Detail of diagonal

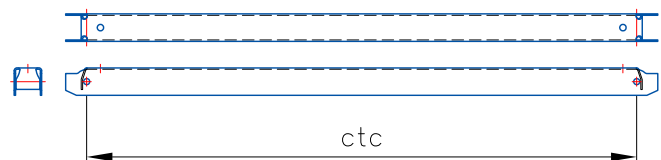

Set SSR Frame 10068204050 5000x1100	Part nr. 50320
Upright 10068204050 PR 355 5000, R5019	2x
Diag. 503015-275 6.6 ctc= 990.00,RAL5019	3x
Diag. 503015-275 6.6 ctc=1087.47,RAL5019	3x
Diag. 503015-275 6.6 ctc=1157.63,RAL5019	3x
Diag. 503015-275 6.6 ctc=1242.01,RAL5019	1x
Bolt hexhd flange M6x 70 zinc 8.8	20x
Nut hex flange selflocking M6 zinc 8.8	20x
Baseplate low 5.0 mm 100, RAL5019	2x
Bolt tapping hexhd M10x 25 zinc 8.8	4x
Nut hex toothed flange M10 zinc 8.8	4x
Washer nonchamfer M10 zinc	4x
CM Shim 100, 1.0 mm, sendz	2x
CM Shim 100, 2.0 mm, sendz	2x

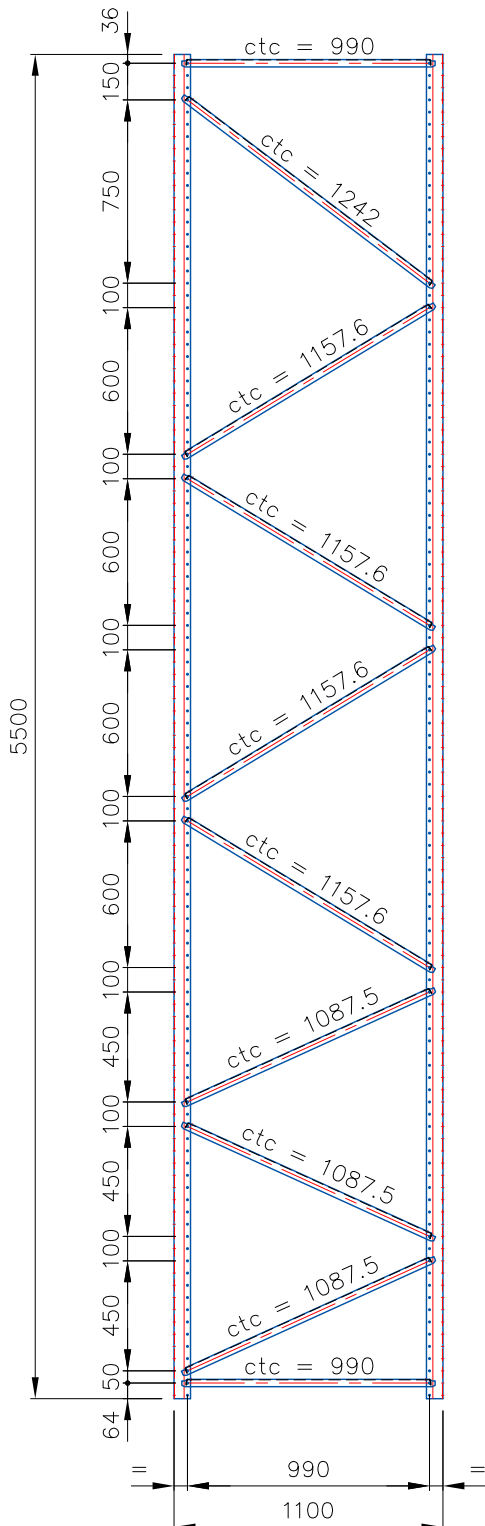

Detail of diagonal

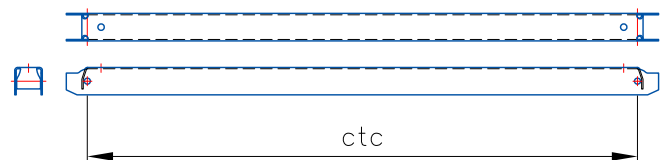

Set SSR Frame 10068204050 5500x1100		Part nr. 50321
Upright 10068204050 PR 355 5500, R5019		2x
Diag. 503015-275 6.6 ctc= 990.00,RAL5019		2x
Diag. 503015-275 6.6 ctc=1087.47,RAL5019		3x
Diag. 503015-275 6.6 ctc=1157.63,RAL5019		4x
Diag. 503015-275 6.6 ctc=1242.01,RAL5019		1x
Bolt hexhd flange M6x 70 zinc 8.8		20x
Nut hex flange selflocking M6 zinc 8.8		20x
Baseplate low 5.0 mm 100, RAL5019		2x
Bolt tapping hexhd M10x 25 zinc 8.8		4x
Nut hex toothed flange M10 zinc 8.8		4x
Washer nonchamfer M10 zinc		4x
CM Shim 100, 1.0 mm, sendz		2x
CM Shim 100, 2.0 mm, sendz		2x

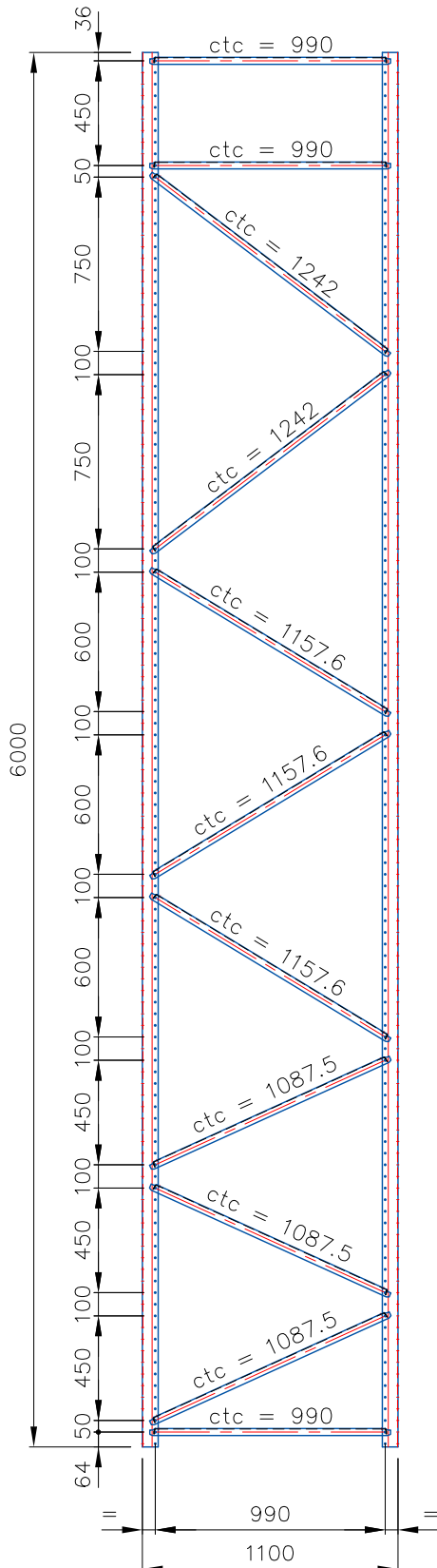

Detail of diagonal

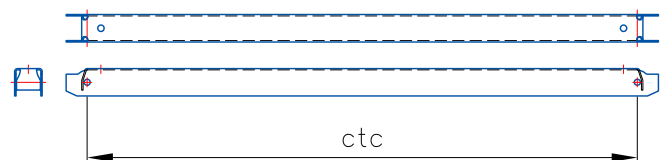

Set SSR Frame 10068204050 6000x1100	Part nr. 50322
Upright 10068204050 PR 355 6000, R5019	2x
Diag. 503015-275 6.6 ctc= 990.00,RAL5019	3x
Diag. 503015-275 6.6 ctc=1087.47,RAL5019	3x
Diag. 503015-275 6.6 ctc=1157.63,RAL5019	3x
Diag. 503015-275 6.6 ctc=1242.01,RAL5019	2x
Bolt hexhd flange M6x 70 zinc 8.8	22x
Nut hex flange selflocking M6 zinc 8.8	22x
Baseplate low 5.0 mm 100, RAL5019	2x
Bolt tapping hexhd M10x 25 zinc 8.8	4x
Nut hex toothed flange M10 zinc 8.8	4x
Washer nonchamfer M10 zinc	4x
CM Shim 100, 1.0 mm, sendz	2x
CM Shim 100, 2.0 mm, sendz	2x

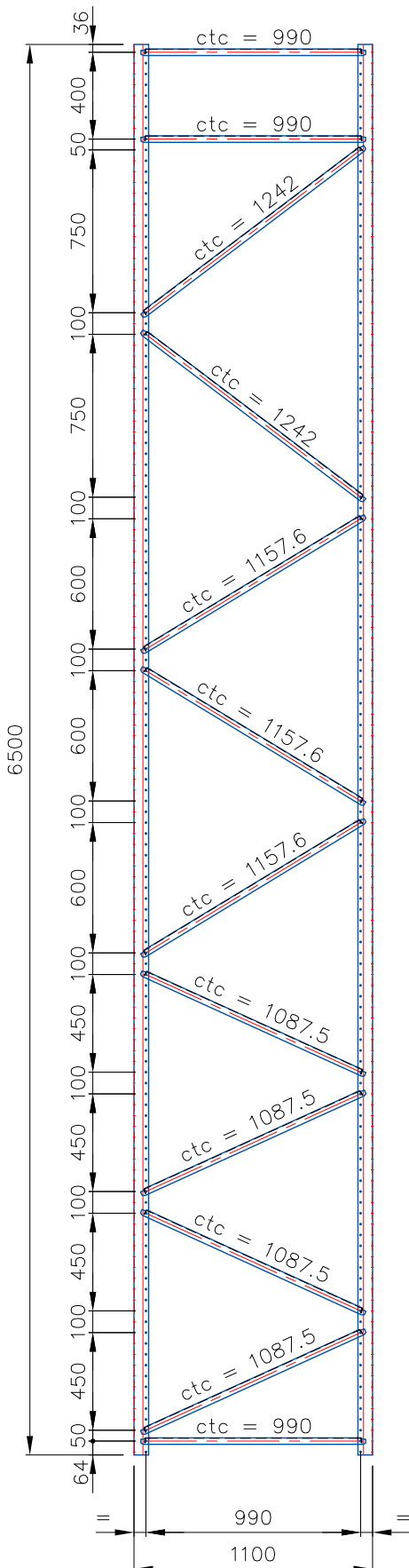

Detail of diagonal

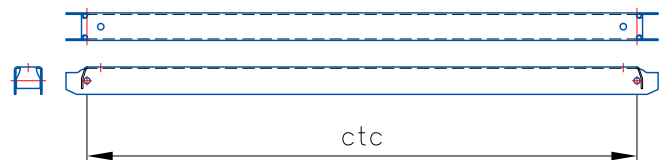

Set SSR Frame 10068204050 6500x1100	Part nr.
	50323
Upright 10068204050 PR 355 6500, R5019	2x
Diag. 503015-275 6.6 ctc= 990.00,RAL5019	3x
Diag. 503015-275 6.6 ctc=1087.47,RAL5019	4x
Diag. 503015-275 6.6 ctc=1157.63,RAL5019	3x
Diag. 503015-275 6.6 ctc=1242.01,RAL5019	2x
Bolt hexhd flange M6x 70 znc 8.8	24x
Nut hex flange selflocking M6 znc 8.8	24x
Baseplate low 5.0 mm 100, RAL5019	2x
Bolt tapping hexhd M10x 25 znc 8.8	4x
Nut hex toothed flange M10 znc 8.8	4x
Washer nonchamfer M10 znc	4x
CM Shim 100, 1.0 mm, sendz	2x
CM Shim 100, 2.0 mm, sendz	2x

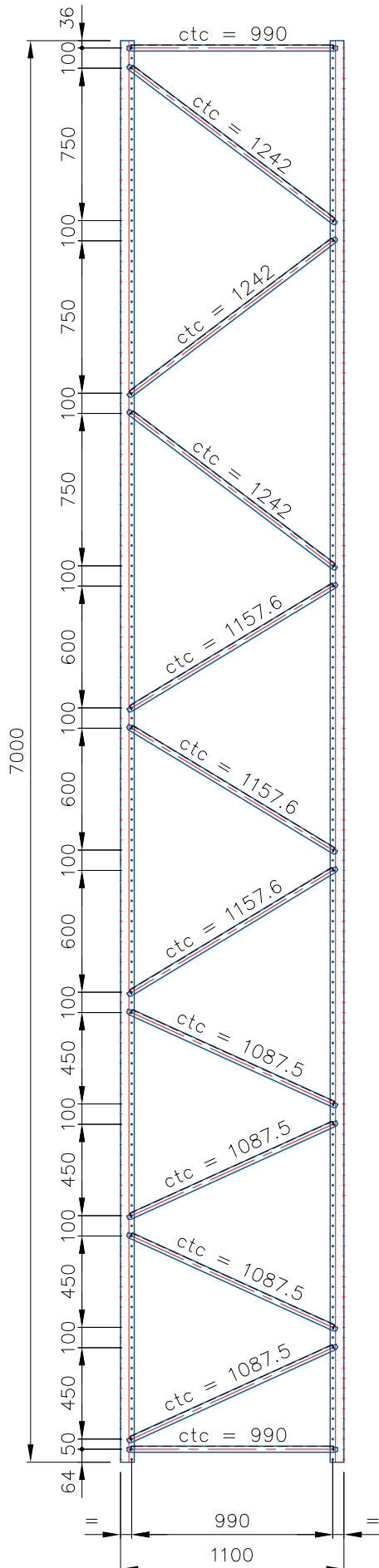

Detail of diagonal

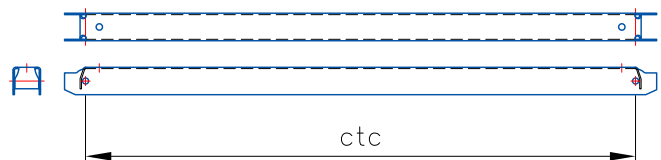

Set SSR Frame 10068204050 7000x1100		Part nr.
		50324
Upright 10068204050 PR 355 7000, R5019		2x
Diag. 503015-275 6.6 ctc= 990.00,RAL5019		2x
Diag. 503015-275 6.6 ctc=1087.47,RAL5019		4x
Diag. 503015-275 6.6 ctc=1157.63,RAL5019		3x
Diag. 503015-275 6.6 ctc=1242.01,RAL5019		3x
Bolt hexhd flange M6x 70 zinc 8.8		24x
Nut hex flange selflocking M6 zinc 8.8		24x
Baseplate low 5.0 mm 100, RAL5019		2x
Bolt tapping hexhd M10x 25 zinc 8.8		4x
Nut hex toothed flange M10 zinc 8.8		4x
Washer nonchamfer M10 zinc		4x
CM Shim 100, 1.0 mm, sendz		2x
CM Shim 100, 2.0 mm, sendz		2x

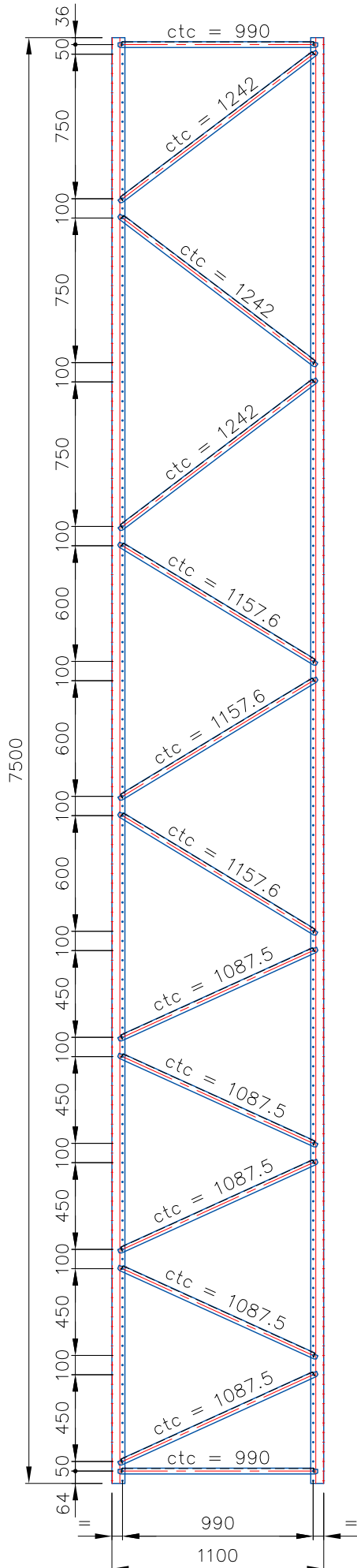

Detail of diagonal

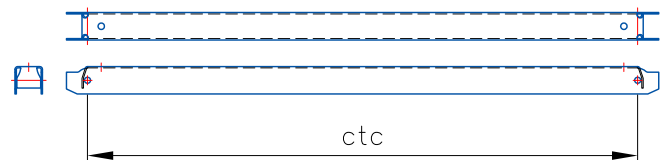

Set SSR Frame 10068204050 7500x1100	Part nr. 50325
Upright 10068204050 PR 355 7500, R5019	2x
Diag. 503015-275 6.6 ctc= 990.00,RAL5019	2x
Diag. 503015-275 6.6 ctc=1087.47,RAL5019	5x
Diag. 503015-275 6.6 ctc=1157.63,RAL5019	3x
Diag. 503015-275 6.6 ctc=1242.01,RAL5019	3x
Bolt hexhd flange M6x 70 zinc 8.8	26x
Nut hex flange selflocking M6 zinc 8.8	26x
Baseplate low 5.0 mm 100, RAL5019	2x
Bolt tapping hexhd M10x 25 zinc 8.8	4x
Nut hex toothed flange M10 zinc 8.8	4x
Washer nonchamfer M10 zinc	4x
CM Shim 100, 1.0 mm, sendz	2x
CM Shim 100, 2.0 mm, sendz	2x

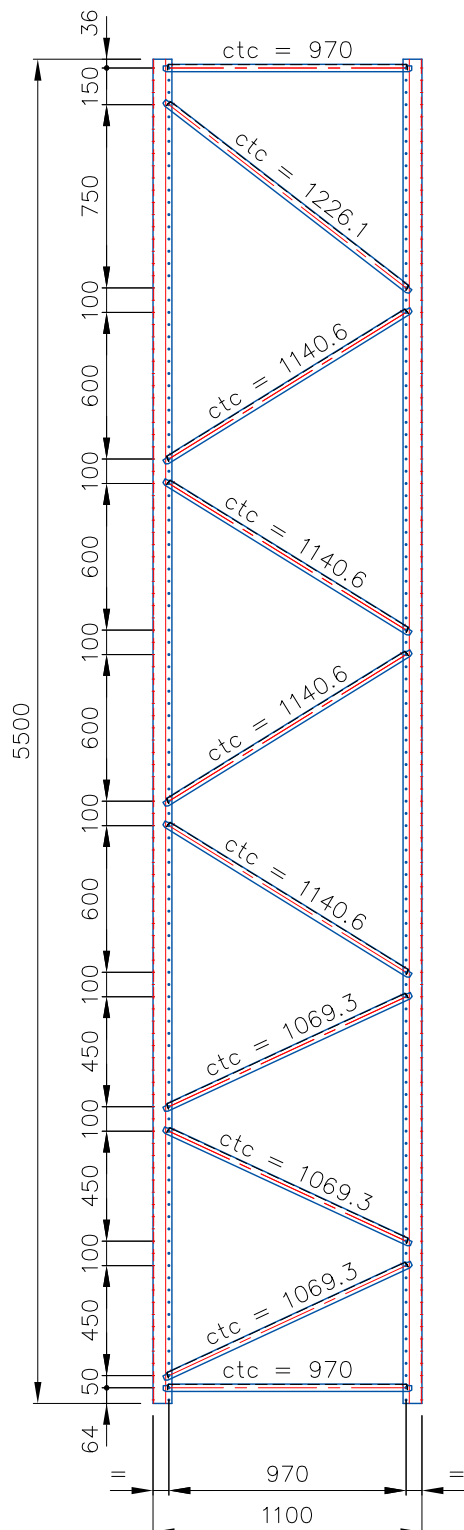

Detail of diagonal

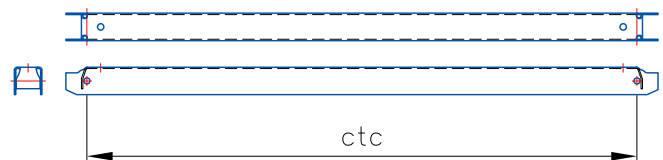

Set SSR Frame 10078255050 5500x1100	Part nr.
	50330
Upright 10078255050 PR 355 5500, R5019	2x
Diag. 503015-275 6.6 ctc= 970.00,RAL5019	2x
Diag. 503015-275 6.6 ctc=1069.29,RAL5019	3x
Diag. 503015-275 6.6 ctc=1140.57,RAL5019	4x
Diag. 503015-275 6.6 ctc=1226.10,RAL5019	1x
Bolt hexhd flange M6x 70 zinc 8.8	20x
Nut hex flange selflocking M6 zinc 8.8	20x
Baseplate low 5.0 mm 100, RAL5019	2x
Bolt tapping hexhd M10x 25 zinc 8.8	4x
Nut hex toothed flange M10 zinc 8.8	4x
Washer nonchamfer M10 zinc	4x
CM Shim 100, 1.0 mm, sendz	2x
CM Shim 100, 2.0 mm, sendz	2x
Pressure plate 100, RAL5019	2x

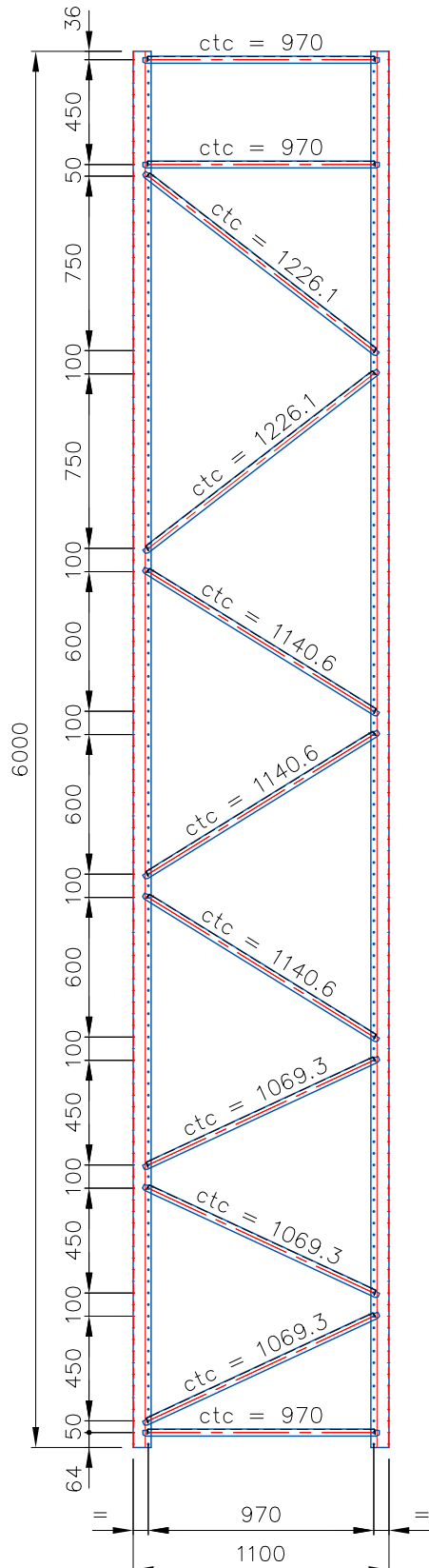

Detail of diagonal

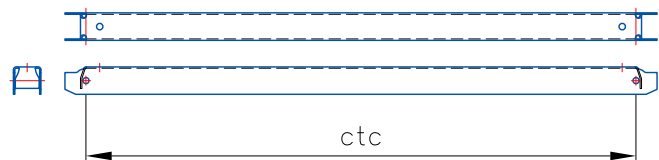

Set SSR Frame 10078255050 6000x1100		Part nr. 50331
Upright 10078255050 PR 355 6000, R5019		2x
Diag. 503015-275 6.6 ctc= 970.00, RAL5019		3x
Diag. 503015-275 6.6 ctc=1069.29, RAL5019		3x
Diag. 503015-275 6.6 ctc=1140.57, RAL5019		3x
Diag. 503015-275 6.6 ctc=1226.10, RAL5019		2x
Bolt hexhd flange M6x 70 zinc 8.8		22x
Nut hex flange selflocking M6 zinc 8.8		22x
Baseplate low 5.0 mm 100, RAL5019		2x
Bolt tapping hexhd M10x 25 zinc 8.8		4x
Nut hex toothed flange M10 zinc 8.8		4x
Washer nonchamfer M10 zinc		4x
CM Shim 100, 1.0 mm, sendz		2x
CM Shim 100, 2.0 mm, sendz		2x
Pressure plate 100, RAL5019		2x

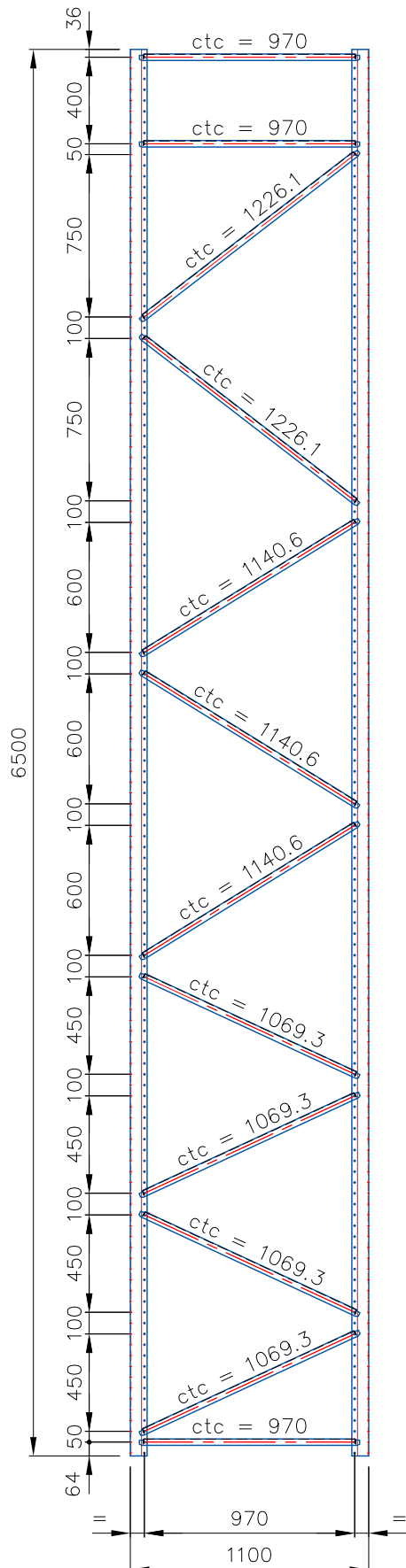

Detail of diagonal

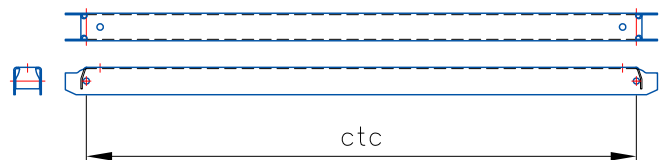

Set SSR Frame 10078255050 6500x1100	Part nr.
	50332
Upright 10078255050 PR 355 6500, R5019	2x
Diag. 503015-275 6.6 ctc= 970.00,RAL5019	3x
Diag. 503015-275 6.6 ctc=1069.29,RAL5019	4x
Diag. 503015-275 6.6 ctc=1140.57,RAL5019	3x
Diag. 503015-275 6.6 ctc=1226.10,RAL5019	2x
Bolt hexhd flange M6x 70 zinc 8.8	24x
Nut hex flange selflocking M6 zinc 8.8	24x
Baseplate low 5.0 mm 100, RAL5019	2x
Bolt tapping hexhd M10x 25 zinc 8.8	4x
Nut hex toothed flange M10 zinc 8.8	4x
Washer nonchamfer M10 zinc	4x
CM Shim 100, 1.0 mm, sendz	2x
CM Shim 100, 2.0 mm, sendz	2x
Pressure plate 100, RAL5019	2x

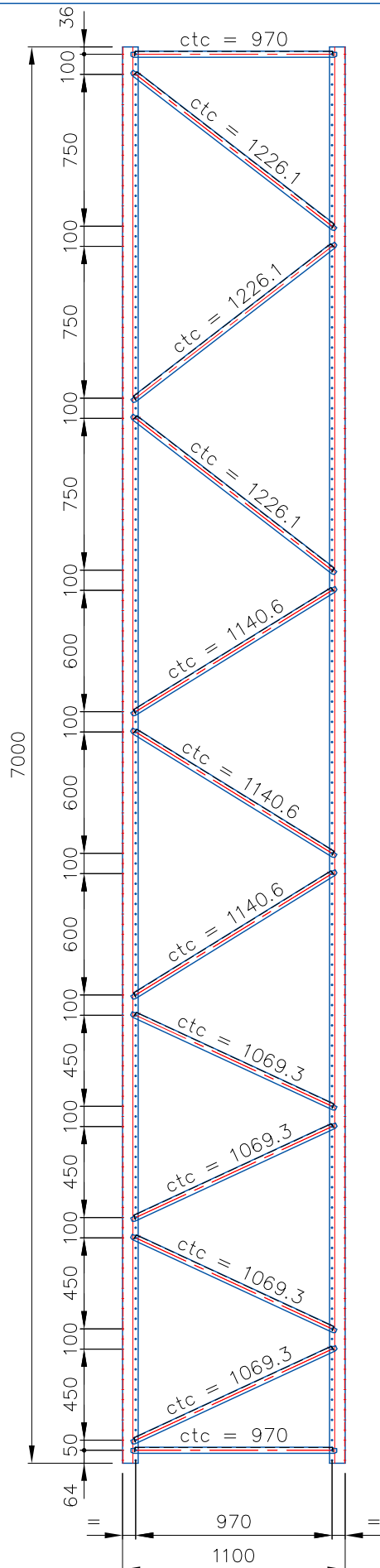

Detail of diagonal

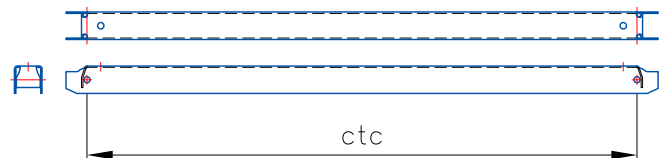

Set SSR Frame 10078255050 7000x1100		Part nr. 50333
Upright 10078255050 PR 355 7000, R5019		2x
Diag. 503015-275 6.6 ctc= 970.00,RAL5019		2x
Diag. 503015-275 6.6 ctc=1069.29,RAL5019		4x
Diag. 503015-275 6.6 ctc=1140.57,RAL5019		3x
Diag. 503015-275 6.6 ctc=1226.10,RAL5019		3x
Bolt hexhd flange M6x 70 znc 8.8		24x
Nut hex flange selflocking M6 znc 8.8		24x
Baseplate low 5.0 mm 100, RAL5019		2x
Bolt tapping hexhd M10x 25 znc 8.8		4x
Nut hex toothed flange M10 znc 8.8		4x
Washer nonchamfer M10 znc		4x
CM Shim 100, 1.0 mm, sendz		2x
CM Shim 100, 2.0 mm, sendz		2x
Pressure plate 100, RAL5019		2x

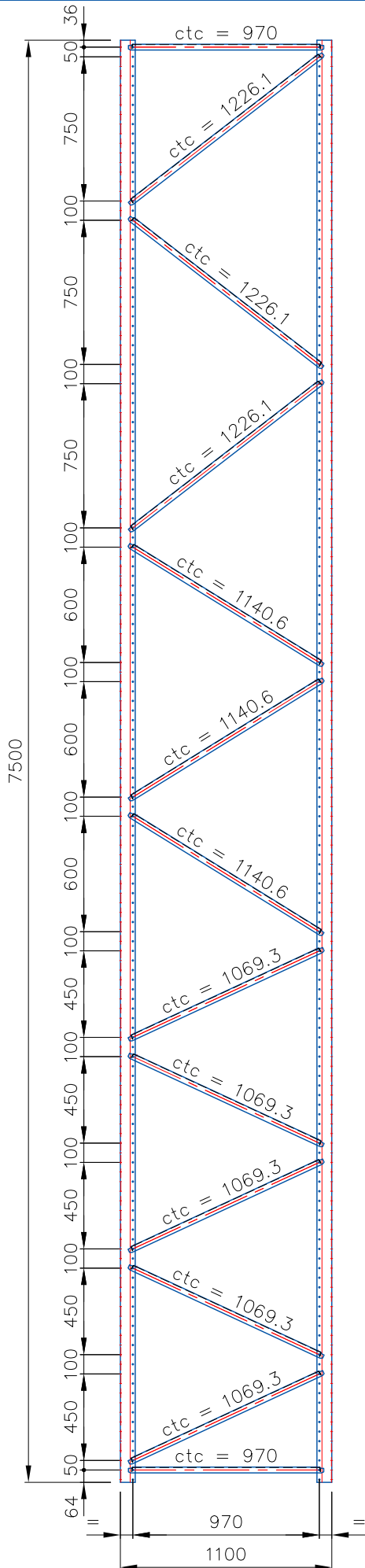

Detail of diagonal

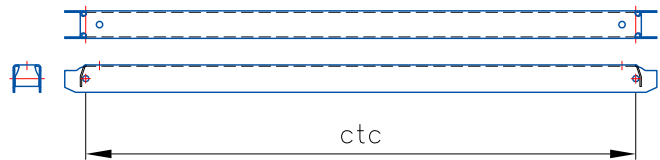

Set SSR Frame 10078255050 7500x1100		Part nr.
		50334
Upright 10078255050 PR 355 7500, R5019		2x
Diag. 503015-275 6.6 ctc= 970.00,RAL5019		2x
Diag. 503015-275 6.6 ctc=1069.29,RAL5019		5x
Diag. 503015-275 6.6 ctc=1140.57,RAL5019		3x
Diag. 503015-275 6.6 ctc=1226.10,RAL5019		3x
Bolt hexhd flange M6x 70 zinc 8.8		26x
Nut hex flange selflocking M6 zinc 8.8		26x
Baseplate low 5.0 mm 100, RAL5019		2x
Bolt tapping hexhd M10x 25 zinc 8.8		4x
Nut hex toothed flange M10 zinc 8.8		4x
Washer nonchamfer M10 zinc		4x
CM Shim 100, 1.0 mm, sendz		2x
CM Shim 100, 2.0 mm, sendz		2x
Pressure plate 100, RAL5019		2x